

PRESS-IN STYLE

Part Numbers	Some Popular Applications	Location	Interchange		
			Moog®	Afco®	Howe®
1210-108 1210-218P 1210-219P	71-87 C10, Impala Spindle, Impala Type Modifieds, Street Stocks	Lower GM	K6117T	20038-1LF	22419
1210-109 1210-208P 1210-209P	70-02 Camaro/Firebird, 73-88 Chevelle/Malibu, 77-96 Impala, 73-88 Monte Carlo, 75-79 Nova/Chevy II, S10, Mini Stocks	Lower GM	K6145T	20039LF	22420
1210-110 1210-210P 1210-211P	67-69 Camaro/Firebird, 64-72 Chevelle/Malibu, 70-72 Monte Carlo, 68-74 Nova/Chevy II, 64-72 GTO, LeMans, Most Popular Modifieds	Lower GM	K5103	20033LF	22421
1210-112 1210-214P 1210-215P	71-76 Impala, All Howe, Rayburn, GRT, Warrior, Port City, Popular Late Model, Most Wide Type Dirt Cars	Lower GM	K6141	-	22413
1210-115 1210-297P	79-93 Mustang	Lower Ford	K8259	-	22426
1210-114 1210-296P	94-04 Mustang	Lower Ford	K8749	-	22400

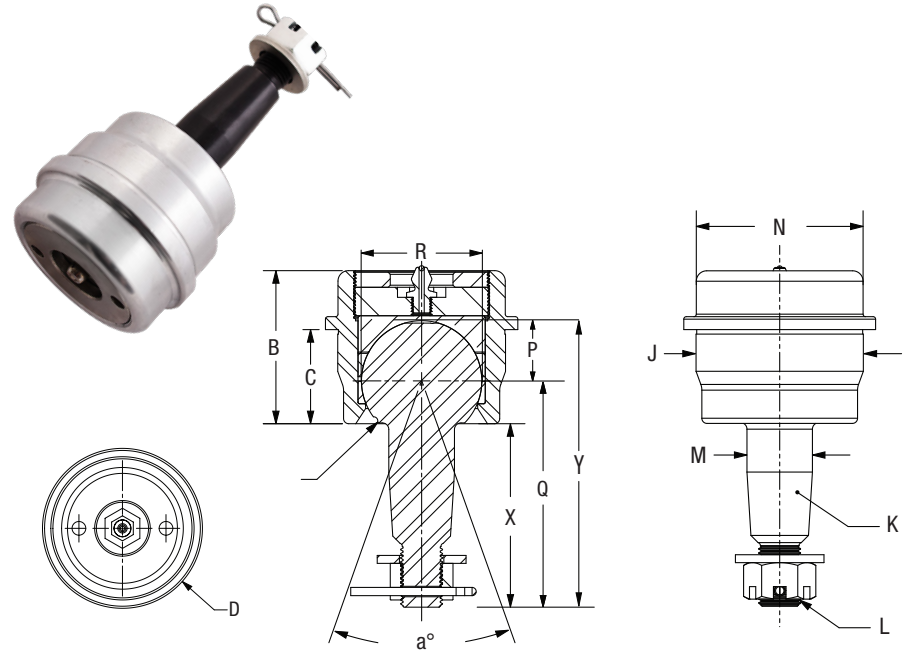

Part Number	Housing Only Part Number	Stud Only Part Number	Length Difference	Stud Length (X)	Stud Length (Y)	Misalign. Angle (a°)	Under Shoulder Length (C)	Housing Depth (B)	Shoulder OD (D)	Press-in Major Dia. (J)	Stud Taper (K)	Stud Thread (L)	Taper Major Dia. (M)	Housing OD (N)	Ball Center from Mounting Flange (P)	Ball Center to End of Stud (Q)	Ball Diameter (R)
1210-108	1210-508	9029-226	Standard	3.230	4.625	44	1.060	2.000	2.250	1.976	2:12	5/8-18	0.872	2.000	0.639	3.651	1.625
1210-218P	1210-508	9029-218	+0.1"	3.330	4.725	44	1.060	2.000	2.250	1.976	2:12	5/8-18	0.872	2.000	0.639	3.751	1.625
1210-219P	1210-508	9029-219	+0.5"	3.730	5.125	44	1.060	2.000	2.250	1.976	2:12	5/8-18	0.872	2.000	0.639	4.151	1.625
1210-109	1210-509	9029-227	Standard	2.440	3.641	64	1.060	1.830	2.250	2.092	2:12	1/2-20	0.784	2.000	0.549	2.951	1.438
1210-208P	1210-509	9029-208	+0.1"	2.540	3.741	64	1.060	1.830	2.250	2.092	2:12	1/2-20	0.784	2.000	0.549	3.051	1.438
1210-209P	1210-509	9029-209	+0.5"	2.940	4.141	64	1.060	1.830	2.250	2.092	2:12	1/2-20	0.784	2.000	0.549	3.451	1.438
1210-110	1210-510	9029-228	Standard	2.190	3.396	64	1.125	1.830	2.300	2.008	1.5:12	1/2-20	0.785	2.000	0.610	2.705	1.438
1210-210P	1210-510	9029-210	+0.1"	2.290	3.496	64	1.125	1.830	2.300	2.008	1.5:12	1/2-20	0.785	2.000	0.610	2.805	1.438
1210-211P	1210-510	9029-211	+0.5"	2.690	3.896	64	1.125	1.830	2.300	2.008	1.5:12	1/2-20	0.785	2.000	0.610	3.205	1.438
1210-112	1210-512	9029-223	Standard	2.410	3.848	42	1.130	2.047	2.375	2.185	2:12	5/8-18	0.830	1.811	0.480	3.06	1.625
1210-214P	1210-512	9029-214	+0.1"	2.510	3.948	42	1.130	2.047	2.375	2.185	2:12	5/8-18	0.830	1.811	0.480	3.16	1.625
1210-215P	1210-512	9029-215	+0.5"	2.910	4.348	42	1.130	2.047	2.375	2.185	2:12	5/8-18	0.830	1.811	0.480	3.56	1.625
1210-115	1210-515	9029-295	Standard	2.770	4.248	50	1.080	2.080	2.250	1.942	1.5:12	5/8-18	0.821	2.000	0.390	3.46	1.625
1210-297P	1210-515	9029-297	+0.5"	2.77	4.748	50	1.080	2.080	2.250	1.942	1.5:12	5/8-18	0.821	2.000	0.390	3.96	1.625
1210-114	1210-514	9029-294	Standard	2.4	3.876	46	1.080	2.080	2.250	1.942	1.5:12	5/8-18	0.852	2.000	0.390	3.09	1.625
1210-296P	1210-514	9029-296	+0.5"	2.4	4.376	46	1.08	2.080	2.250	1.942	1.5:12	5/8-18	0.852	2.000	0.390	3.59	1.625

DIMENSIONS IN INCHES