



DON'T FORGET

These instructions can be found in color and expandable at QA1.net

Technical Support Line: (952) 985-5675 Email: sales@QA1.net

INSTALLATION INSTRUCTIONS

*QA1 Hx05 2005-2014 S197 Mustang Coil-over Struts
CC115, 2005-2014 Caster-Camber Plates*

TOOLS AND SUPPLIES REQUIRED

- Floor Jack
- Torque Wrench
- T-15 Torx Bit
- Jack Stands
- Spring Compressor (Optional)
- 24mm or 15/16" Crows Foot Wrench
- Lug Wrench
- Basic Tool Set

PRE-INSTALLATION NOTE:

QA1 struts were designed for a 0"-2" lowered ride height. Caster-Camber plates were designed for additional negative Camber and increased positive Caster for better handling performance.

QA1 struts were designed to work with QA1 caster-camber plates and will not work with the factory upper strut mount.

REMOVAL

1. Start your installation by inspecting your chassis. Look for worn/deteriorated bushings, ball joints, etc. If anything is worn, plan to replace during this installation.
2. Loosen the four nuts holding the factory upper strut mount to the chassis. **(Figure 1)** Leave the nuts loosely in place at this time.
3. Jack the car up and ensure the frame is set in place securely on jack stands. See your owner's manual for proper jacking techniques. Remove the wheels.
4. Position the floor jack under the ball joint cup only to support the control arm.
5. Remove the brake line, ABS wire and end-links from the existing strut body and sway bar. **(Figure 2)** A new end link is provided with the QA1 strut, so the factory end link can be discarded.
6. Loosen and remove the two nuts and bolts that attach the strut to the spindle knuckle. **(Figure 2)**
7. Remove the four nuts on the top side of the chassis holding the strut assembly. Hold/support the strut assembly during this step so as to not have the strut fall out of the car.

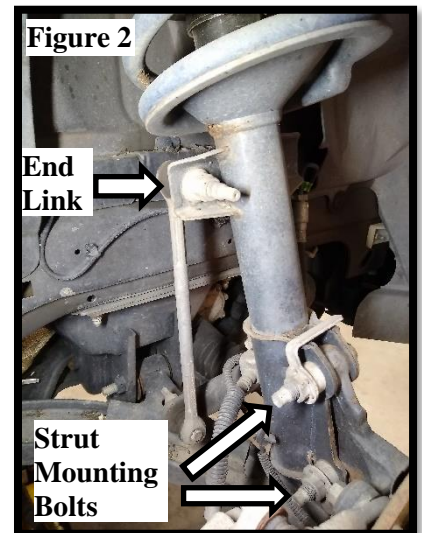
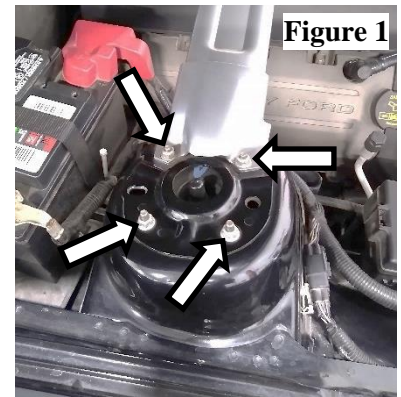

PRE-INSTALLATION NOTE:

Using a dremel, trim the circle on the strut tower to allow for easier access to the caster/camber adjustments. **(Figure 3)**

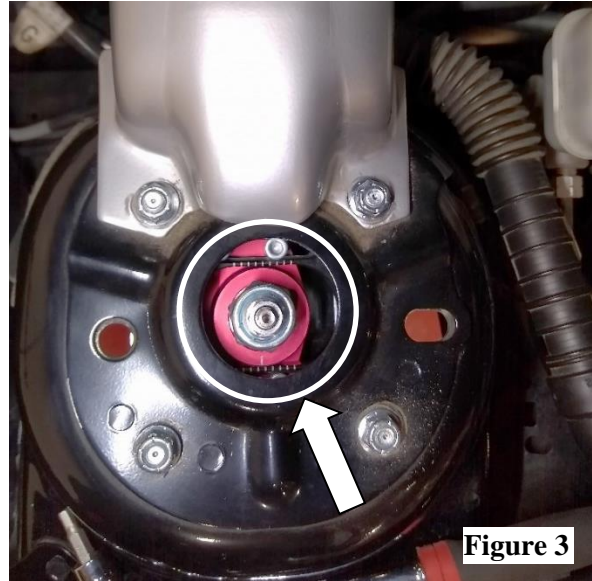

INSTALLATION:

1. In preparation for assembling the strut, remove the strut adjustment knob using a Torx T-15 tool. **(Figure 4)**
2. Remove the wiper boot from the top of the black threaded area of the strut. **(Figure 5)**

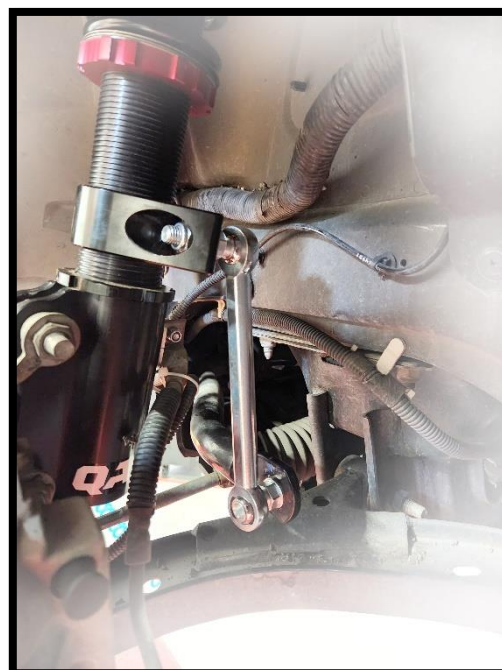
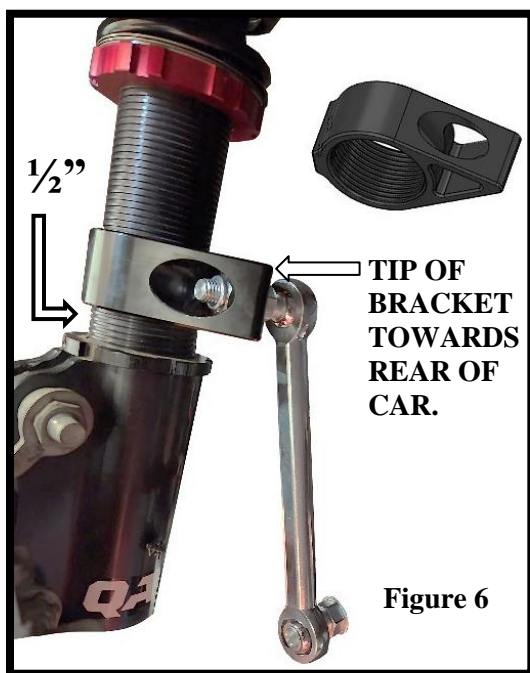
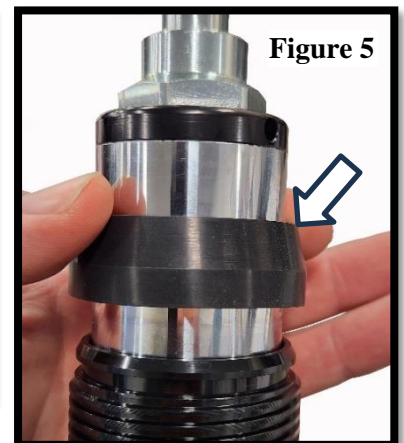

3. Thread the sway bar end link bracket down the threads of the strut body, leaving 1/2" of threads visible between the sway bar link and the lower locking collar. This bracket features two set screws to hold it in place, but it is not necessary to set the position until the sway bar end link is re-attached. **(Figure 6)**

4. Thread the spring seat collar (#2) down the body of the strut with the shouldered end UP.
5. Coat one side of the stainless steel spring seat washer (#3) (included with each strut) with **Permatex® Anti-Seize Lubricant**.
6. Reinstall the wiper boot ensuring the boot is seated in the groove of the threaded portion of the strut. (**Figure 5**)
7. Install the spring onto the strut, followed by the upper spring seat (#4).
8. Install the 1" I.D. thrust bearing kit onto the top of the upper spring seat to create a "bearing sandwich". (#5, #6, #5)
9. Install the bearing retainer (#7) onto the strut.

BALLOON #	ITEM #	DESCRIPTION	QTY.
1	9013-104	SET SCREW, SOCKET HEAD 5/16-18 X .5"	1
2	9019-180	NUT, SPRING SEAT 2.5", 2.205" X 8 TPI	1
3	9005-109	WASHER, SPRING SEAT 2.5" ID	1
4	9018-138	SPRING SEAT, STRUT, C/O 2.5" SPRING	1
5	9006-101	THRUST WASHER, 1.00" ID	2
6	9010-101	BEARING, THRUST 1" ID	1
7	9018-105	STRUT COIL-OVER BEARING RETAINER	1



10. Place the strut rod through the caster camber plate and install one SG104 spacer with the narrow end facing down, followed by the strut retaining nut. (**Figure 7**) These caster-camber plates are not right left specific, so either one can be mounted on either side as long as the QA1 logo is mounted towards the outboard side of the car.)
11. Install the large strut nut. Holding the small hex at the top of the strut rod, torque the 24mm strut nut to 45 lb. ft.
12. Reinstall the adjustment knob onto the strut rod. Torque to 10 inch lbs.

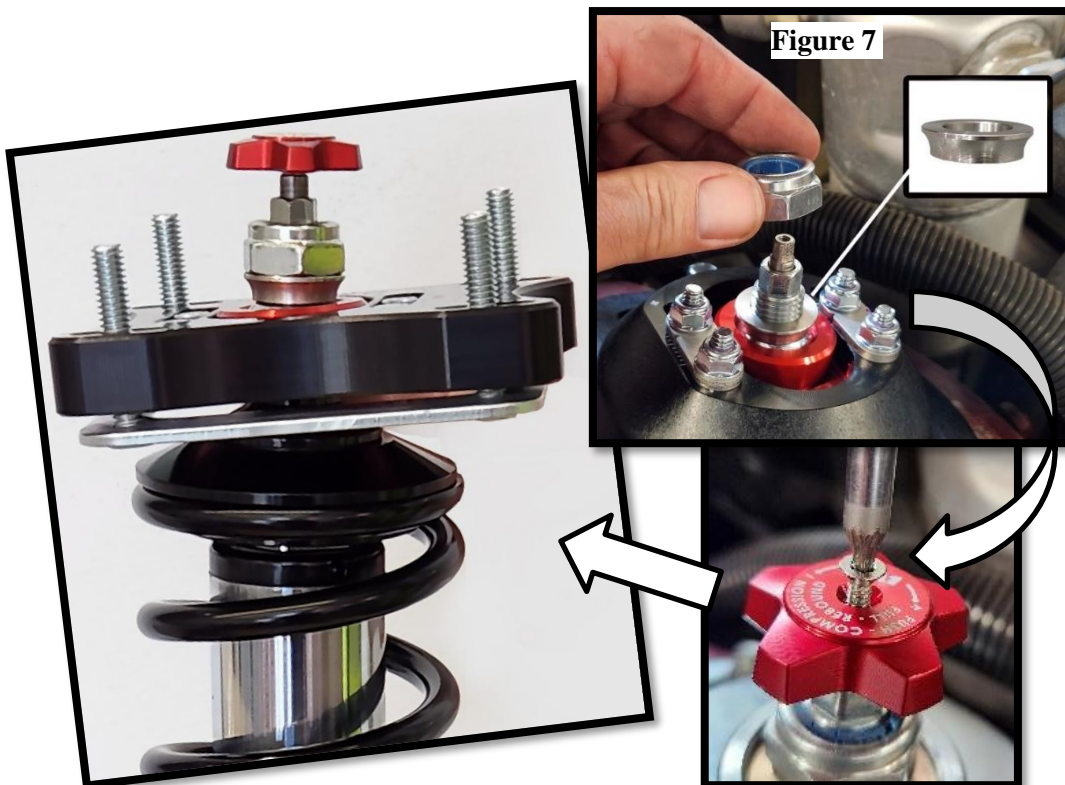

1. Remove the four nuts holding the plates together (**#5**), but DO NOT separate the two plates.
2. Install the complete driver and passenger strut with caster-camber plates from the underside of the strut tower with the posts coming up through the chassis. The QA1 logo on the caster-camber plates should be mounted to the outboard side of the vehicle. (Logo away from the engine)
3. Secure the plates to the strut tower using 5/16" nyloc nuts (**#5**). Torque to 18 lb. ft. (**Figure 3**)

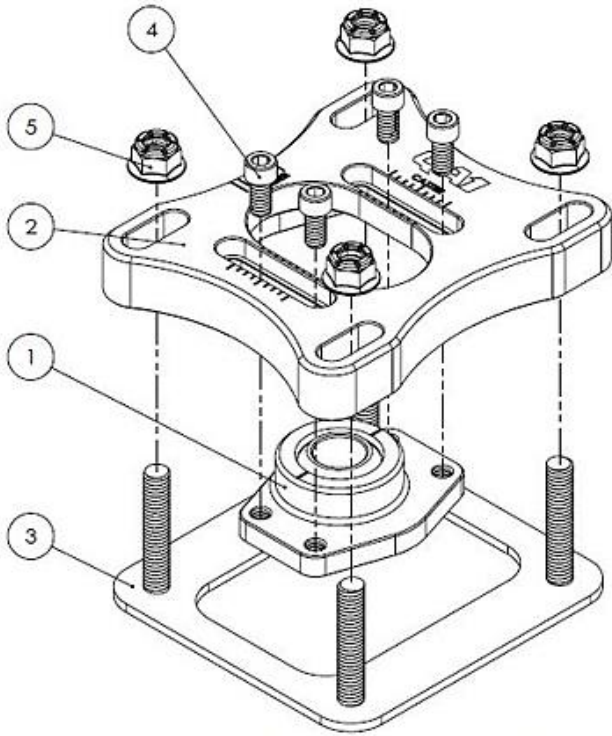

BALLOON #	ITEM #	DESCRIPTION	QTY.
1		BEARING PLATE ASM. 16MM W/THREADS	2
2	7730-123	PLATE, BILLET UPPER CC	2
3	9039-348	MOUNT PLATE, CC LOWER	2
4	9012-332	BOLT, SHCS 1/4-20 X .5"	8
5	9014-538	NUT, HEX FLANGE NYLOCK 5/16-18	8

↑ FRONT OF CAR ↑

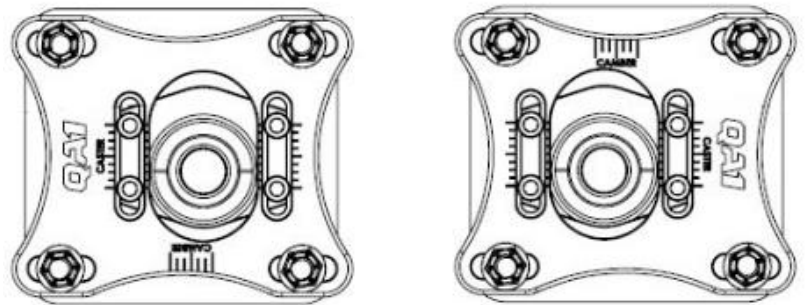

13. Position the spindle knuckle into the bracket on the strut. (**Figure 8**)
14. Install the two spindle mounting bolts and nuts. Torque to 148 lb. ft.



15. Reinstall the brake line to the bracket on the strut using a 1/4" bolt and nut. **(Figure 9)** Torque to 9 lb. ft.
16. Re-install the ABS wire with the included zip tie it to the brake line.
17. Install the included sway bar link to the sway bar and strut body mount **(Figure 10)** using the included M12 washers and nuts. Torque to 65 lb. ft.
18. With the sway bar end link connected, secure the end link mount to the strut body by snugging the 5/16" nylon tip set screws into the bracket. **(Figure 11)**
19. Reinstall the wheels. Torque all nuts and bolts to factory specification.
20. Repeat the entire removal and installation procedures for the other side of the vehicle.
21. Double check all work. It's a basic and overlooked practice that distinguishes the most effective builders from the rest.
22. Take the car to a reputable alignment shop and have the car aligned.

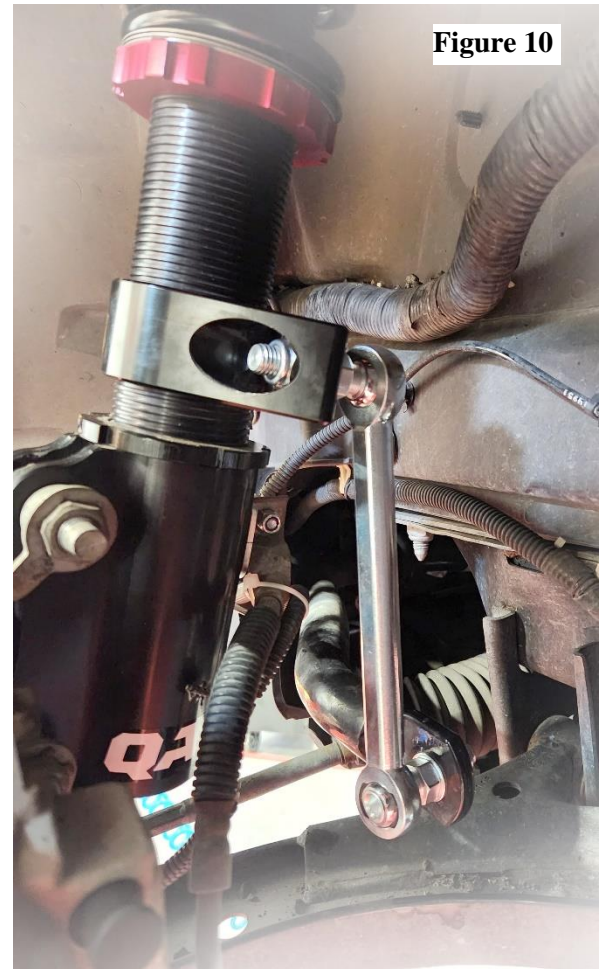

Front Strut Valving Adjustments

QA1 struts have 18 damping settings adjusted at the knob on top of the strut. The knob set fully counter-clockwise is the softest setting -start your adjustments from this point. **Do not force the knob past the 18th click or it could cause damage to the valving.** Single adjustable struts soften or firm the rebound valving while having a fixed compression. Double adjustable struts have independent compression and rebound adjustments. The function of the adjustment knob on Single Adjustable and Double Adjustable struts is as follows:



SINGLE ADJUSTABLE- Turn the adjustment knob counter-clockwise until the knob stops- This is the softest setting. Turn the knob clock-wise to firm the rebound.

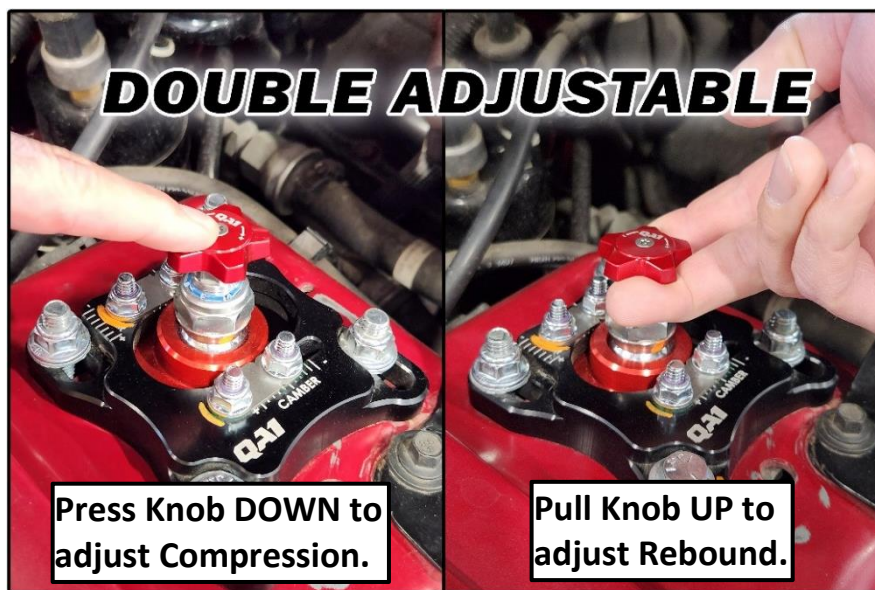

DOUBLE ADJUSTABLE- Pressing the adjustment knob DOWN will adjust the Compression valving of the strut. Pulling the adjustment knob UP will adjust the Rebound valving. Out of box, the strut should be at zero compression and rebound setting, or both adjustments turned counter-clockwise to stop. From the zero setting with the knob in the Compression position (pushed down), adjust clockwise to the desired setting. The Rebound setting will remain in the zero position. To adjust Rebound, pull the knob up to the Rebound adjust position and adjust clockwise to the desired setting. Either setting can now be adjusted up or down from the initial setting. When in doubt, turn the Compression to zero and then Rebound to zero and readjust.

Recommended base settings to begin testing with are as follows:

Single (Rebound) Adjust Struts:

Applications:

- 2-8 clicks for nice ride and handling
- 8-12 clicks for firm ride and improved handling
- 13+ clicks for more aggressive handling

Double Adjust Struts:

Drag Racing:

Drag Racing Tie-Down

Other Applications:

- 12-16 clicks Compression, 0-6 clicks Rebound
- 2-6 clicks Compression, 12-18 clicks Rebound
- 2-6 clicks Compression, 2-8 Rebound for nice ride and handling
- 8-12 clicks Compression, 8-12 Rebound firm ride & improved handling
- 12-16 clicks Compression, 13+ clicks Rebound more aggressive handling

A PROFESSIONAL WHEEL ALIGNMENT IS RECOMMENDED BEFORE DRIVING THE VEHICLE.

Recommended Alignment Specs:

Camber $-1^{\circ} \pm 0.75$

Caster $+7.1^{\circ} \pm 0.75$

Total toe: $0.2^{\circ} \pm 0.05$



READ ALL INSTRUCTIONS CAREFULLY AND THOROUGHLY PRIOR TO STARTING INSTALLATION. PRODUCTS THAT HAVE BEEN INSTALLED ARE NOT ELIGIBLE FOR RETURN. USE THE PROPER JACKING LOCATIONS. DEATH OR SERIOUS INJURY CAN RESULT IF INSTRUCTIONS ARE NOT CORRECTLY FOLLOWED. A GOOD CHASSIS MANUAL, AVAILABLE AT YOUR LOCAL PARTS STORE, MAY ALSO AID IN YOUR INSTALLATION.

• DISCLAIMER / WARRANTY •

QA1 WARRANTS THAT THE PRODUCTS WILL BE FREE FROM DEFECTS IN MATERIAL AND WORKMANSHIP FOR ONE YEAR FROM DATE OF SALE TO THE ORIGINAL PURCHASER. QA1 MAKES NO OTHER WARRANTY OF ANY KIND, EXPRESSED OR IMPLIED. QA1 SHALL HAVE NO OBLIGATION UNDER THE FOREGOING WARRANTY WHERE THE DEFECT IS THE RESULT OF IMPROPER OR ABNORMAL USE, YOUR NEGLIGENCE, VEHICLE ACCIDENT, IMPROPER OR INCORRECT INSTALLATION OR MAINTENANCE, NOR WHEN THE PRODUCT HAS BEEN REPAIRED OR ALTERED IN ANY WAY. QA1'S LIABILITY IN THE CASE OF DEFECTIVE PRODUCTS SUBJECT TO THE FOREGOING WARRANTY SHALL BE LIMITED TO THE REPAIR OR REPLACEMENT, AT QA1'S OPTION, OF THE DEFECTIVE PRODUCTS.

THE USER UNDERSTANDS AND RECOGNIZES THAT RACING PARTS, SPECIALIZED STREET ROD EQUIPMENT, AND ALL PARTS AND SERVICES SOLD BY QA1 ARE EXPOSED TO MANY AND VARIED CONDITIONS DUE TO THE MANNER IN WHICH THEY ARE INSTALLED AND USED. QA1 SHALL BEAR NO LIABILITY FOR ANY LOSS, DAMAGE OR INJURY, EITHER TO A PERSON OR TO PROPERTY, RESULTING FROM THE INSTALLATION, DIRECT OR INDIRECT USE OF ANY QA1 PRODUCTS OR INABILITY BY THE BUYER TO DETERMINE PROPER USE OR APPLICATION OF QA1 PRODUCTS. WITH THE EXCEPTION OF THE LIMITED LIABILITY WARRANTY SET FORTH ABOVE, QA1 SHALL NOT BE LIABLE FOR ANY CLAIMS, DEMANDS, INJURIES, DAMAGES, ACTIONS, OR CAUSES OF ACTION WHATSOEVER TO BUYER ARISING OUT OF OR CONNECTED WITH THE USE OF ANY QA1 PRODUCTS. MOTORSPORTS ARE DANGEROUS; AS SUCH, NO WARRANTY OR REPRESENTATION IS MADE AS TO THE PRODUCT'S ABILITY TO PROTECT THE USER FROM INJURY OR DEATH. THE USER ASSUMES THAT RISK!

DEDICATED TECH SUPPORT

QA1 is dedicated to providing quality support and instructions. We employ passionate racers and car enthusiasts that know our products and the industry to better serve you.

CHECK US OUT ON YOUTUBE!



- Frequently Asked Questions
- Quick Tips
- Install Information
- Tuning and Repair Guides
- Other Technical Information



- linkedin.com/company/qa1
- instagram.com/qa1motorsports
- facebook.com/qa1motorsports

youtube.com/qa1tech

www.qa1.net/tech